



Cast Marble Solutions for Your Showers



60" x 30" Shower Base with LH or RH Drain

SB60x30-8.5-XH-LC

Est. Weight: 140 lbs (64 kg) IMI LiteCast™

TECHNICAL SPECIFICATIONS

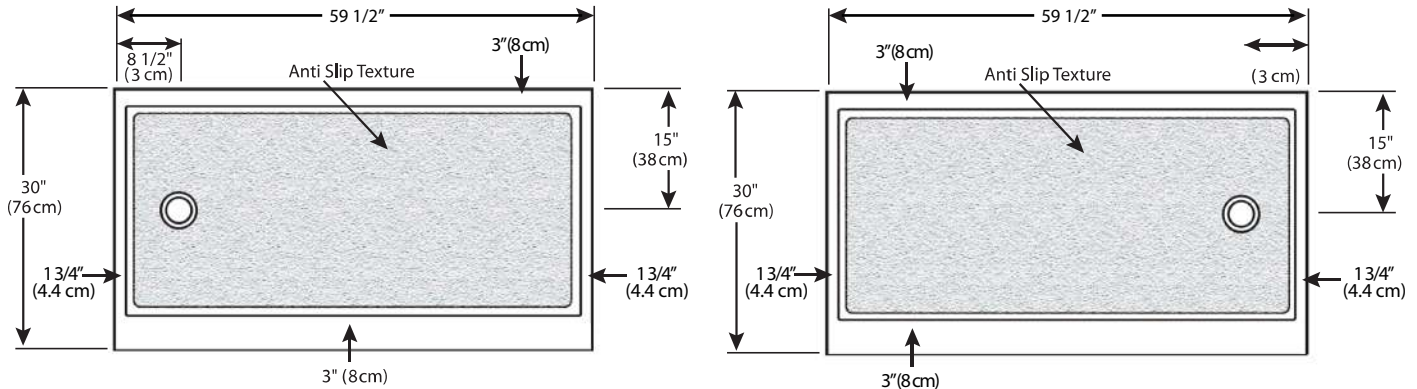

Note: Pan dimensions vary +/- 1/8"

Suggested Drains:



Solvent Weld type fitting similar to Oatey Part No. 42097



Compression type "No-Caulk" fitting similar to Oatey Part No. 42099

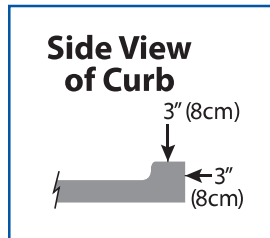

Standard Features:

- Available in Left Hand and Right Hand version
- Designed for tub replacements
- Integral Curb
- 3" (8 cm) Wide thresholds on front
- Solid one-piece construction
- Pre-leveled, rests on subfloor
- Mold and mildew resistant
- Bacteria resistant
- "Grout-free" and non-porous
- Stain resistant and easy to clean
- Waterproof and leakproof
- Fiberglass Flange

Drain Details: (U.S.)

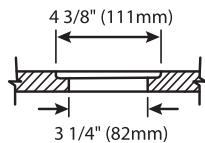

Flange Details: (U.S.)

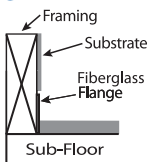

***Note: Pan dimensions may vary +/- 1/8"**

Our products comply with one or more of the following: IAPMO, ANSI, HUD, NAHB, NHQ

*Also available in IMI LiteCast™ and IMI ProCast™

Typical CSI Codes: 22 42 23 (Div. 22)

Revised 2018.09.05

© 2018 Copyright IMI International Marble Industries, Inc.



INTERNATIONAL MARBLE INDUSTRIES, INC.

304 Bell Park Drive

Woodstock, GA 30188

770.928.2252

www.IMItoday.com