



# 60" x 34" - 4" Trench Drain LH or RH Shower Base

SB-60x34-4TD-xH-LC

Est. Weight: ~114 lbs (52 kg) IMI LiteCast™

TECHNICAL SPECIFICATIONS

**Top View - Left Drain**

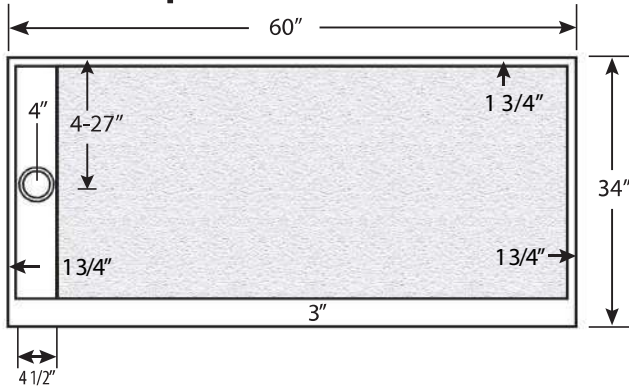

**Top View - Right Drain**

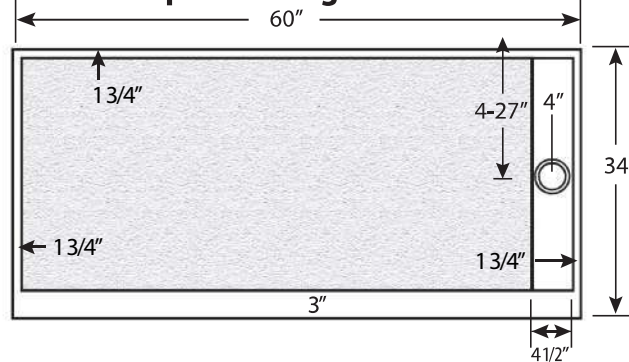

**Front View - Left Drain**

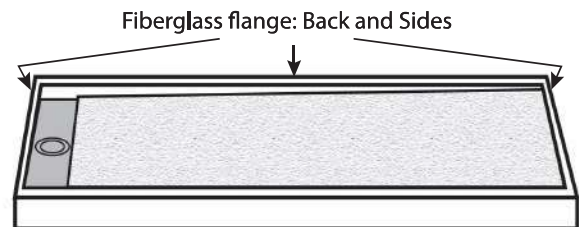

**Front View - Right Drain**

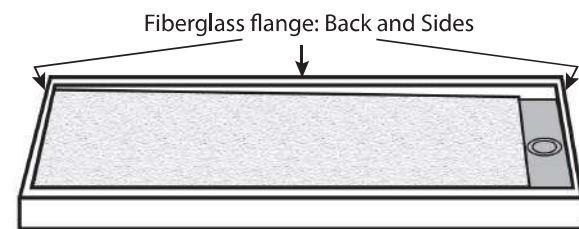

## Standard Features:

- Solid one-piece construction
- Pre-leveled - rests on subfloor
- Mold and mildew resistant
- Bacteria resistant
- Textured non-slip finish
- Abrasion resistant gel coat surface
- Stainless steel trench drain cover

## Specifications:

- Size: 60" x 34" Size
- Drain Location: Center of drain measures 4" from side of pan  
4-27" from backwall
- Flange: Fiberglass
- Trench: 4 1/2" width

## Suggested Drains:

- Solvent Weld type fitting similar to Oatey Part No. 42097
- Compression type "No-Caulk" fitting similar to Oatey Part No. 42099

**Drain Details: (U.S.)**

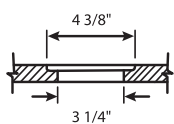

**Side View of Curb**

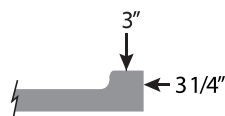

**FLANGE DETAILS (US):**

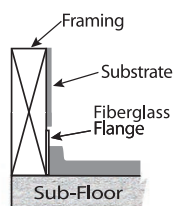

**Drain Cover**

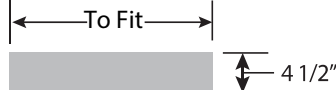

**Note: Base dimensions may vary +/- 1/8"**

\* Also available in IMI ProCast™

Our products comply with one or more of the following: IAPMO, ANSI, HUD, NAHB, NHQ

22 42 23 (Div 22)

Revised: 2019.03.16

© 2019 Copyright IMI International Marble Industries, Inc.

