



Adjustable Shower Base w/ LH or RH Trench Drain

SB-ADJ-CUSTOM-TD

IMI LiteCast™

TECHNICAL SPECIFICATIONS

Customized to your individual specifications with fiberglass waterdam.
Curb attached by plant or in field.

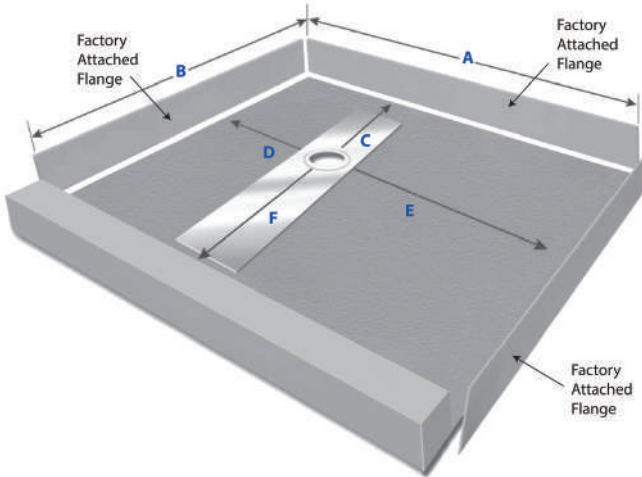

Note: Pan dimensions vary +/- 1/8"

Standard Features:

- Solid one-piece construction, including fiberglass flanges, **chemically bonded to base** (upon request)
- Pre-sloped to the drain
- Rests on sub-floor
- Mold, mildew and bacteria resistant
- "Grout-free" and non-porous
- Stain resistant and easy to clean
- Abrasion resistant gel coat surface
- Waterproof and leak-proof

Dimensions:

- A** = 66" max.
- B** = 34" max. (w/a curb 36")

Drain Location:

- C** = 26.5" max. / 8" min.
- D** = 12" max. / 3.5" min.
- E** = 54" max. / 3.5" min.
- F** = 26.5" max. / 8" min.

Suggested Drains:

- Solvent Weld type fitting fitting similar to Oatey Part No. 42097
- Compression type "No-Caulk" fitting similar to Oatey Part No. 42099



NOTE: Pan dimensions may vary +/- 1/8"

Curb Cross-Section View:

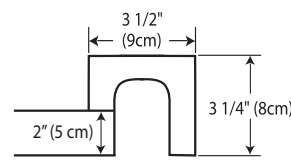

Flange Details: (U.S.)

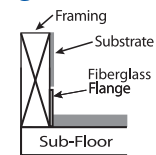

Drain Details: (U.S.)

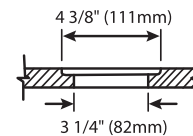

* Also available in IMI LiteCast™ and IMI ProCast™

Our products comply with one or more of the following: IAPMO, ANSI, HUD, NAHB, NHQ

Typical CSI Codes: 22 42 23 (Div. 22)

Revised: 2018.06.04

© 2018 Copyright IMI International Marble Industries, Inc.