

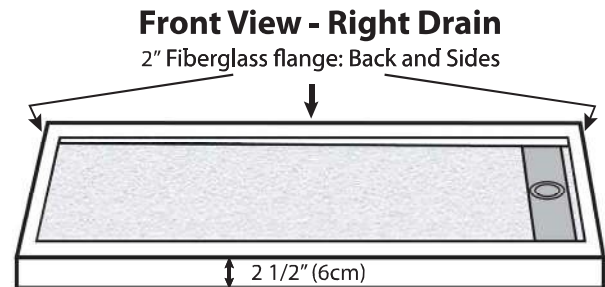

60" x 32"- 8" Low Profile Trench Drain LH or RH Shower Base SB60x32 8LPTD-XH-LC

Est. Weight: 120 lbs (54 kg) **IMI LiteCast™**

TECHNICAL SPECIFICATIONS

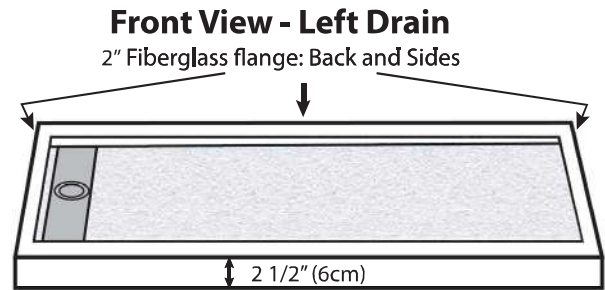
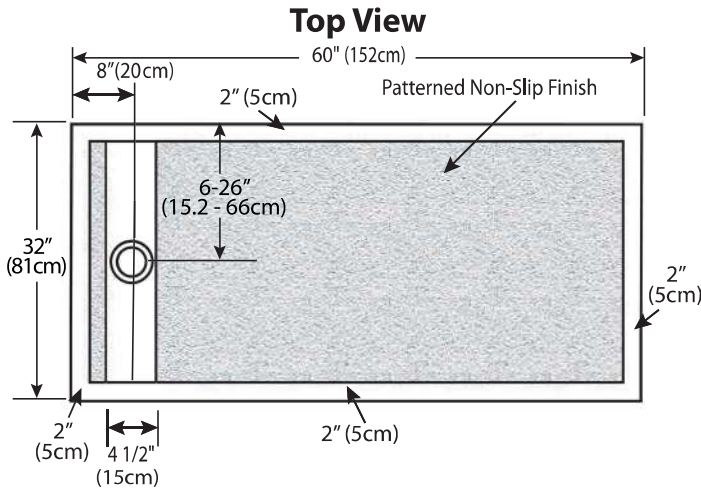

Side View of Curb

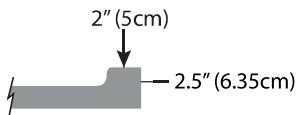

Drain Details: (U.S.)

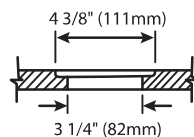

Flange Details: (U.S.)

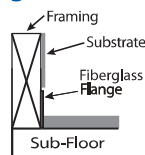

Drain Cover

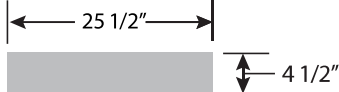

Note: pan dimensions vary +/- 1/8"

Suggested Drains:

- Solvent Weld type fitting similar to Oatey Part No. 42097
- Compression type "No-Caulk" fitting similar to Oatey Part No. 42099

Standard Features:

- Solid one-piece construction
- Pre-leveled - rests on subfloor
- Mold and mildew resistant
- Bacteria resistant
- Textured non-slip finish
- Abrasion resistant gelcoat surface
- Stainless steel trench drain cover

Specifications:

- Size: 60" x 32" Size
- Drain Location: Center of drain measures 8" from side of pan 6-26" from backwall
- Flange: Fiberglass
- Trench: 4 1/2" width

Typical CSI Codes: 06 10 00 (06100), 06 20 00 (06200), 12 30 33 (06400) 12 36 61.13 (06610), 22 42 23 (Div 15), 22 00 00 (Div 15), 06 61 13 (Div 06)

Revised 2017.09.05

© 2014 Copyright IMI International Marble Industries, Inc.

Our products comply with one or more of the following: IAPMO, ANSI, HUD, NAHB, NHQ

All products made of cultured marble, also known as MasterCast Engineered Composites, Cast Stone, Stone Resin, Resine de Pierre or Marbre de Synthèse (French), Mineral Guss (German), Polybeton (Dutch)